

CLIPS NO	X	C	W	N	Weight (Kg)
BEKET 107/40/13	20	40	55	13	1,375
BEKET 107/40/17	20	40	55	17	1,385
BEKET 107/40/24	20	40	55	24	1,395
BEKET 107/50/13	30	50	65	13	1,620
BEKET 107/50/17	30	50	65	17	1,635
BEKET 107/50/24	30	50	65	24	1,650

TECHNICAL SPECIFICATIONS

- Max side load 170 kN
- Lateral adjustment 18 mm
- Bolt M20 Grade 8.8
- Tightening Torque 350 Nm
- Steel Quality St52-3

1 | RAIL WITH PAD

2 | RAIL WITHOUT PAD

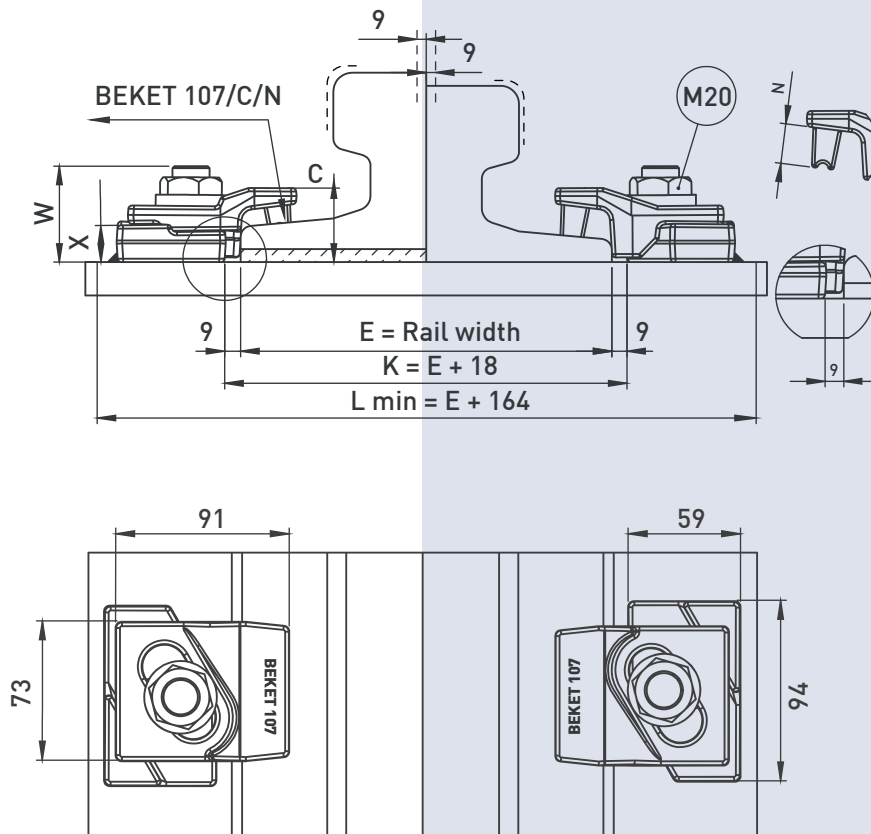

MAIN FEATURES

1. BEKET 107 welded rail clips, which are produced from 2 forged parts as upper and lower enables ease of assembly thanks to its special desing.
2. The clips can preferred for rails with or without pads.
3. The two main parts are locked together with special bolt.
4. The rubber nose increases the tolerances of the rail support structures, reduces the stress of the connections, allows a better fixing of the rail.

COMPONENTS

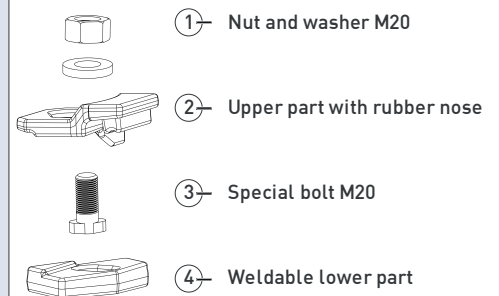
- 
1. Nut and washer M20
 2. Upper part with rubber nose
 3. Special bolt M20
 4. Weldable lower part

- Flange nut can also be used on request. Please consult us for using flange nut.

107

Beket 107 Welded Rail Clips

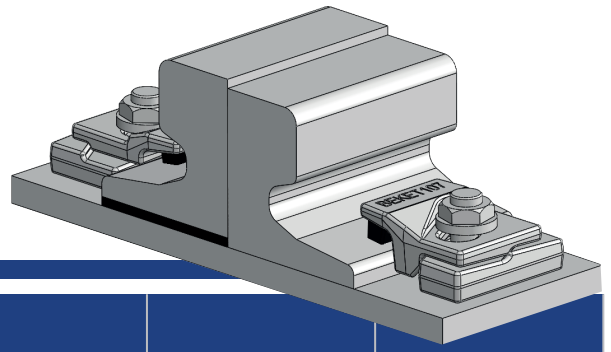

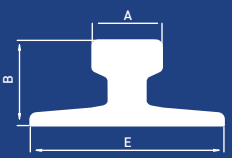
	A	B	E	Without Pad	With Pad
A75	75	85	200	107/40/24	107/40/17
A100	100	95	200	107/40/24	107/40/13
A120	120	105	220	107/40/17	107/40/13
A150	150	150	220	107/40/17	107/50/17
CR104	63,5	127	127	107/40/17	107/40/13
CR105	65,1	131,8	131,8	107/40/24	107/40/13
CR135	76,2	146	131,8	107/40/17	107/40/13
CR175	102,4	152,4	152,4	107/40/17	107/40/13
S49	67	149	125	107/40/24	107/40/13
UIC 54	70	159	140	107/40/24	107/40/13
UIC60	72	172	150	107/40/24	107/40/13
54E2	67	161	125	107/40/24	107/40/13
54E3(S54)	67	154	125	107/40/24	107/40/13
56E1	69,85	158,75	140	107/40/24	107/40/13
60E2	72	172	150	107/40/24	107/40/13
P43	70	140	114	107/40/24	107/40/13
P50	72	152	132	107/40/17	107/40/13
P65	73	180	150	107/40/17	107/40/13
KP70	70	120	120	107/40/24	107/40/13
KP80	80	130	130	107/40/24	107/40/13
KP100	100	150	150	107/40/17	107/40/13
MRS 87 A	101,6	152,4	152,4	107/40/17	107/50/17
MRS 125	120	180	180	107/50/24	107/50/17

Clip can be with more type of rails than those listed.

WELD DETAIL

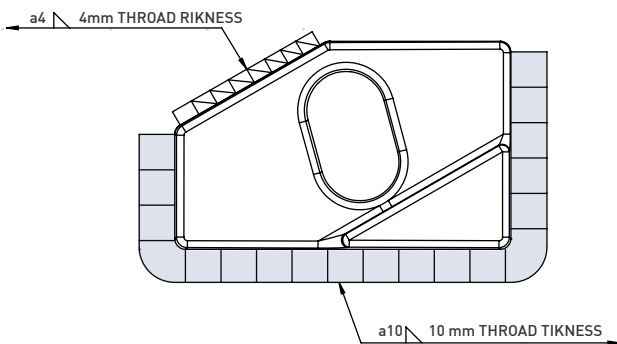

INSTALLATION INSTRUCTIONS:

Weld all round the clip base, except the side closest and parallel to the rail with a 10 mm throat thickness fillet weld, using low hydrogen electrodes. Recommended electrodes AWS E7018 or E7028. Clip base is made from weldable grade steel. Please consult us for continuous welding requirement.

ELEKTRODE

AWS A5.1 1-04 E7018-1
EN ISO 2560-A E42 & B42 H5
CE EN 13479

ROD

AWS A5.18 ER 70S-6: SG3
EN ISO 1668 W 4Si1: SG3



Deutsche
Akkreditierungsstelle
D-ZM-12007-01-00



TÜRKAK BDS NO
Y5-2809-9621