

CLIPS NO	X	W	Weight (Kg)
BEKET 4018	18	41	0,385

TECHNICAL SPECIFICATIONS

- Max side load 60 kN
- Lateral adjustment 6 mm
- Bolt M20 Grade 8.8
- Tightening Torque 220 Nm
- Steel Quality St52-3

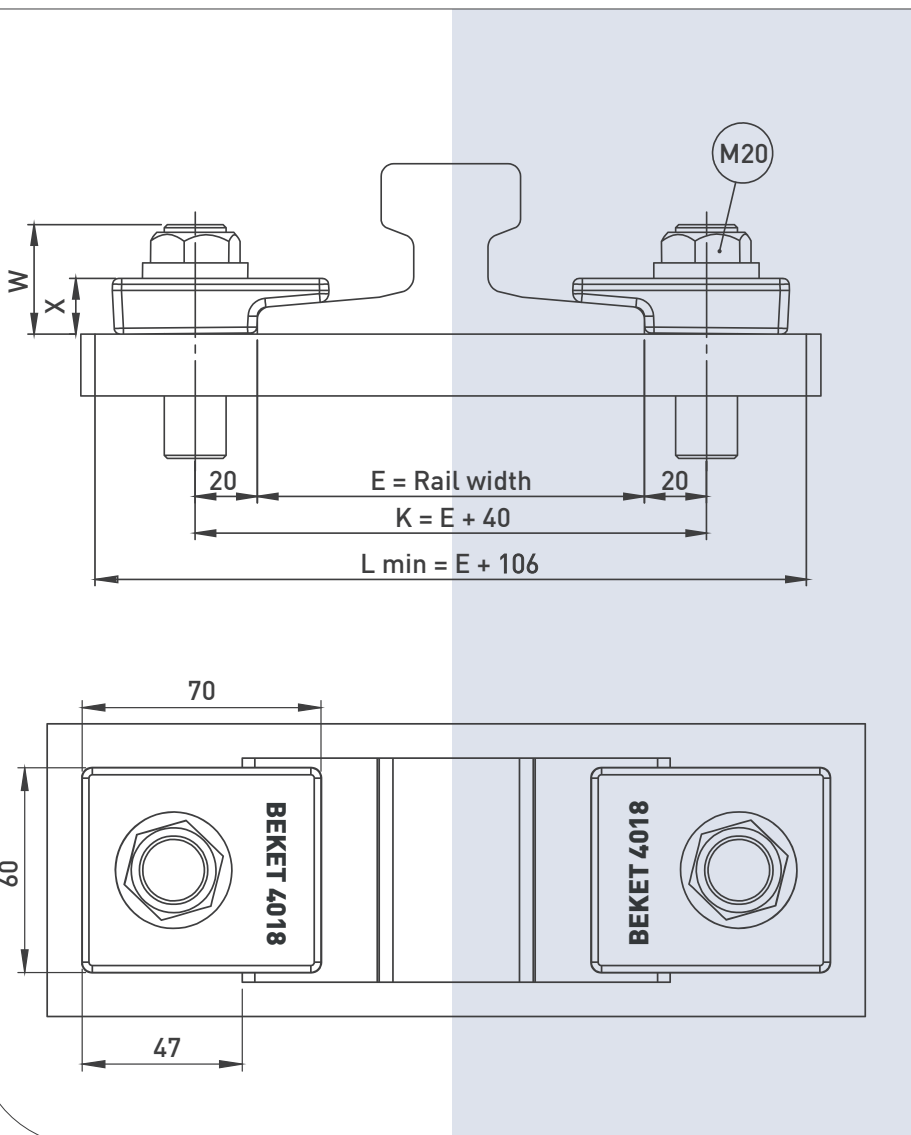

MAIN FEATURES

- 1- BEKET 4018 bolted rail clip, which is produced from a forged part, enables ease of assembly thanks to its special design.
- 2- The clips can be preferred for rails with or without pads.
- 3- The main part is locked to rail with M20 bolt.

- Flange nut can also be used on request. Please consult us for using flange nut.

4018

Beket 4018 Bolted Rail Clips

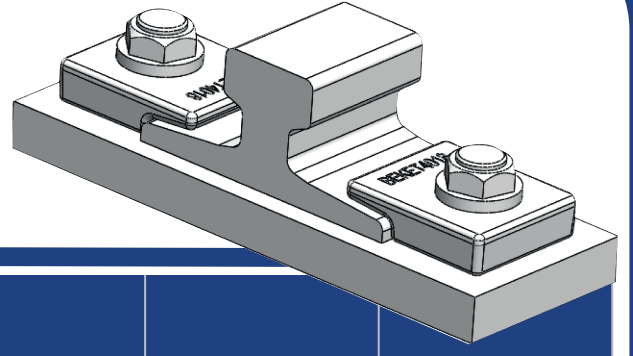

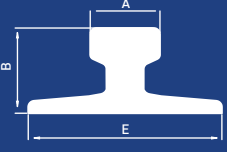
	A	B	E	Without Pad	With Pad
A45	45	55	125	4018	-
A55	55	65	150	4018	-
A65	65	75	175	4018	-
A75	75	85	200	-	-
A100	100	95	200	-	-
A120	120	105	220	-	-
A150	150	150	220	-	-
S10	32	70	58	4018	-
S14	38	80	70	4018	-
S18	43	93	82	4018	-
S20	44	100	82	4018	-
S24	53	115	90	4018	-
S30	60,3	108	108	4018	-
S31	56	125	106	-	-
S33	65	145	135	4018	-
S41 A	67	138	125	4018	-
S49	67	149	125	-	-
54 E1 (UIC54)	70	159	140	-	-
60 E1 (UIC60)	72	172	150	-	-

Clip can be with more type of rails than those listed.

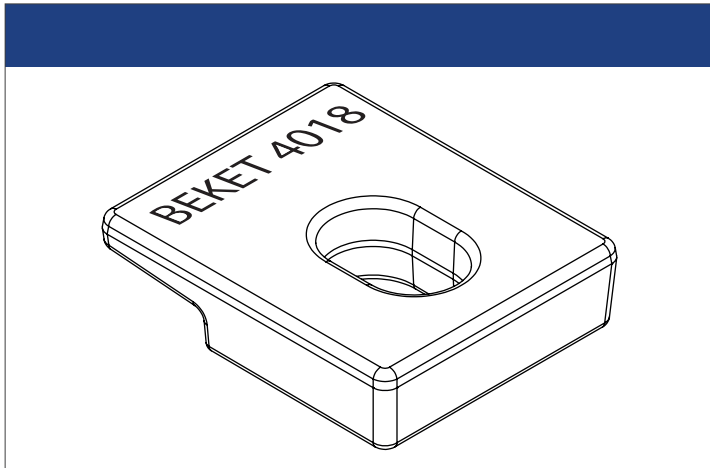

INSTALLATION INSTRUCTIONS:

The main component is first positioned on the bolt against the rail and the special washer is then positioned on the main component. The nut is hand tightened. Hammer is used for tighter contact. The main component is in position, use an electrical or pneumatic wrench to torque the nut. Please contact BEKET for full installation instructions.

